

- NO. OF UNITS  
- 132
- CAR PARKING  
- 47 SPACES INCLUDING 2 DISABLED
- CYCLE PARKING - COMMERCIAL  
- LONG STAY 1 SPACE PER 200SQ m GFA = (2)  
- SHORT STAY 1 SPACE PER 100SQ m GFA = (4)
- CYCLE PARKING - FLATS  
- LONG STAY 1 SECURE SPACE PER UNIT  
(+ 2 ADDITIONAL SPACES) = (134)
- MOTORCYCLE PARKING  
- 1 MOTORCYCLE PER 25 CAR SPACES = (2)
- BINS - FLATS  
250L PER FLAT  
(1x125L GENERAL, 1x125L RECYCLING)  
PROVISION FOR 32 1100L EUROBINS
- BINS - COMMERCIAL  
- 3 BINS PER COMMERCIAL UNIT

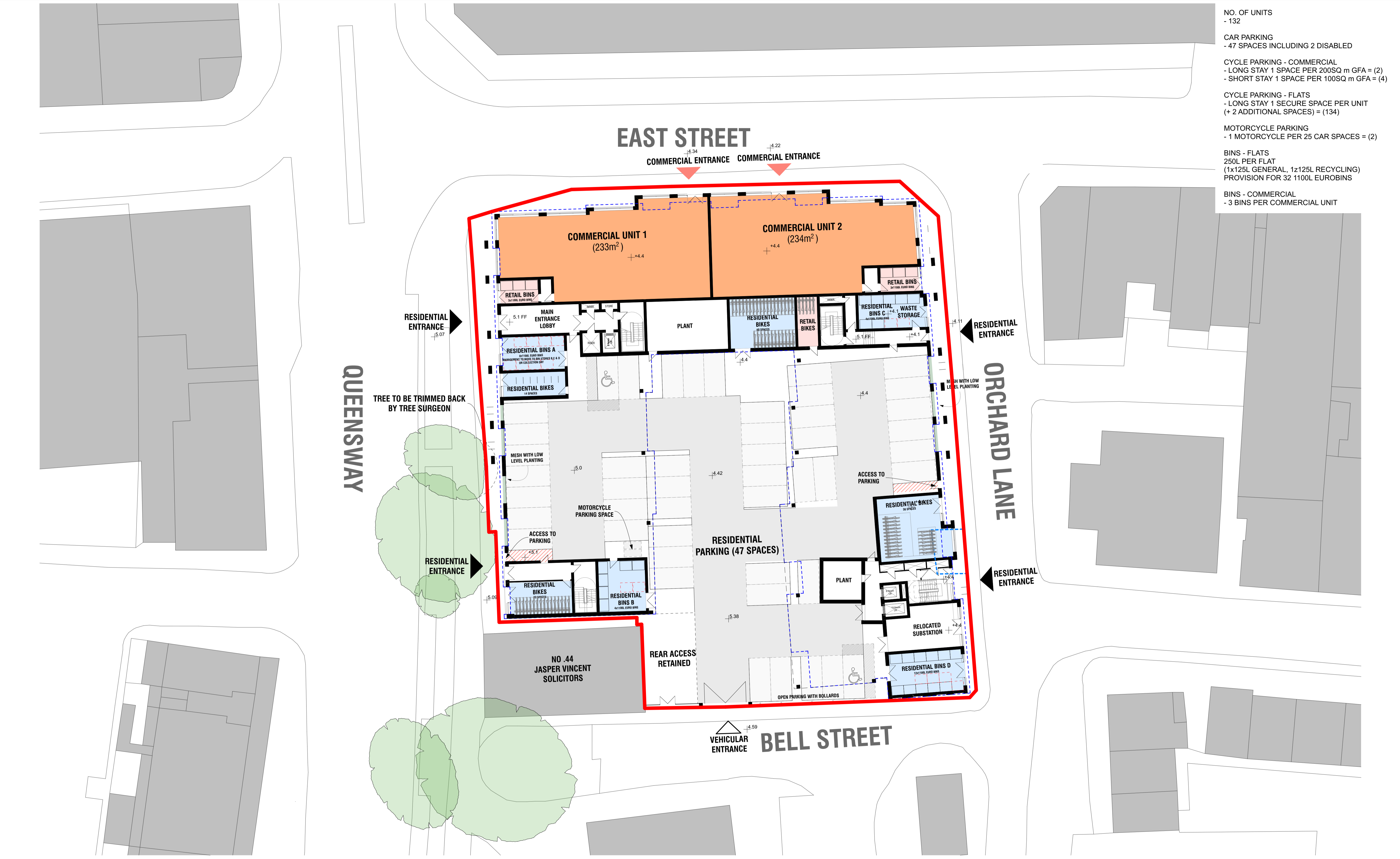

NO.	DATE	DESCRIPTION	BY	CHECKED
M	07/11/2017	ADJUSTED TEXT IN DRAWING KEY	SR	
L	09/10/2017	ADJUSTED PARKING LAYOUT TO INCREASE CYCLE ACCESS WIDTH TO BIKE STORE	SR	
K	03/07/2017	REDUCED BUILDING FOOTPRINT EXTERNALLY BY 300mm	SR	
J	07/05/2017	SWAPPED NEW SUBSTATION LOCATION OVER WITH BIKE STORE	SR	
I	19/01/2017	ARMORED BIN / BIKE STORE TO ALLOW COLLECTION FROM BELL STREET	SR	
H	25/10/2016	Commercial bins amended	SR	CK
G	05/10/2016	Bin Stores and Bike Stores amended	SR	CK
F	19/09/2016	SIXTH FLOOR AMENDED	JP	CK
E	13/09/2016	Floors Added, Flats Amended	JP	CK
D	24/08/2016	Bins amended	JP	CK
C	19/08/2016	Car park amended, doors open inwards, cycle parking amended	JP	CK
B	08/07/2016	Plot numbers added, drawing numbers amended	JP	CK
A	05/07/2016	For Planning	JP	CK

**PLANNING**

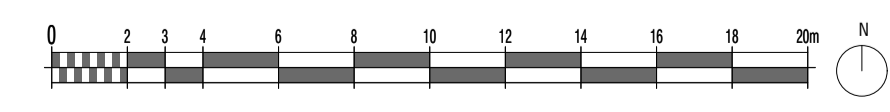

CLIENT  
**HAMPSHIRE & REGIONAL**  
PROPERTY GROUP

TITLE  
EAST STREET, SOUTHAMPTON  
PROPOSED GROUND FLOOR

**HGP** ARCHITECTS  
FURZEHALL FARM, WICKHAM ROAD  
FARHAM, HAMPSHIRE, PO16 7JH  
T: 01329 283 225  
F: 01329 237 004  
E: EMAIL@HGP-ARCHITECTS.CO.UK  
W: WWW.HGP-ARCHITECTS.CO.UK

Scale @ A1: 1:200  
Date: July 2017 ©  
Drawn by: SP  
Checked by: CK  
Drawing No: 15.097.102

Revision: M  
HGP Architects Ltd.  
Copyright Reserved.  
Check dims. on site.